

# Blue Containers Transition

## Introduction

Aj. Ruciro, Tan Pasado, Tan Cittadhammo and Eleonora had a meeting on the 6th of April about the storage situation related to the phase 7b+ and the blue containers. ADL asked that we should make a decision about how many to keep ASAP as we are renting them for 10 GBP/week/unit for the 8 storage containers and 25GBP/week/unit for the 2 Larder Containers.

## Map

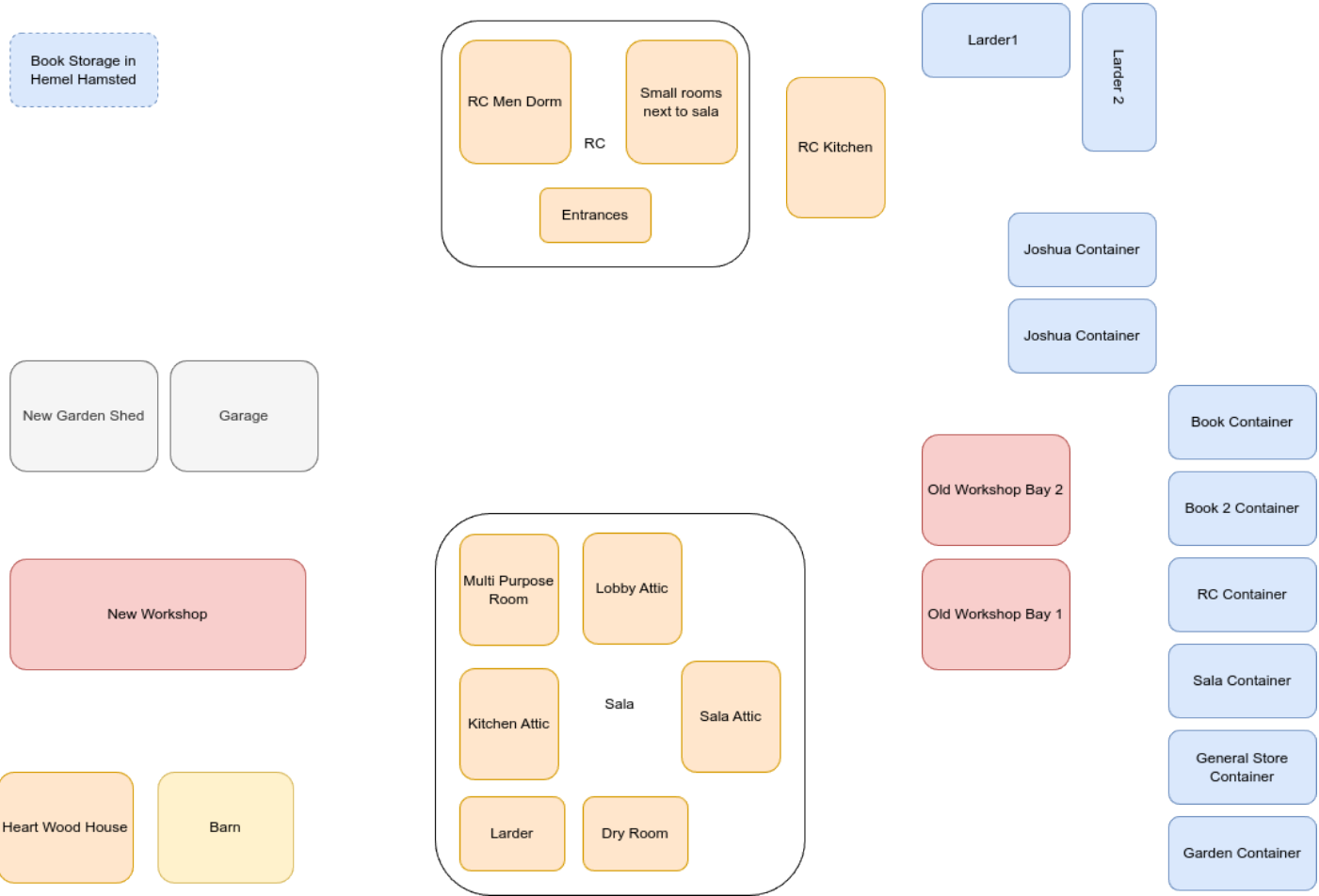

# Plan

## Books

The initial plan was to move the book into the old workshop (see [Storage](#)), but as the old workshop will go down within the next few years, it makes more sense to have them store for the long term in containers until the office block is built (10+ years)

The books need storage area for cardboard boxes (with plastic sealing bag) and office spaces for handling and management with open shelves providing good temperature and humidity. The containers need to be accessible with a pallet lifter for deliveries (Joshua containers are perfect for that)

It was estimated that the two larger containers (office container) could be used for the book store equipments and office presently located in the Bhikkhu Vihara and the two Joshua containers could be used to store the remaining book boxes.

**Containers** needed:

1. Office Container (larger type)
2. Office Container (larger type)
3. Storage Container (with fork lift access)
4. Storage Container (with fork lift access)

If we move the larger containers next to Joshua containers, then it will make a unified book store area until the office block is built. These four containers can be moved with a crane if needed during construction phase (?)

## Old workshop

As the old workshop will only be available for a few years before its demolition, it will be used for temporary living spaces for monks (Gym, monk storages, communal spaces)

## Cloth and bedding store

Cloth is highly sensitive to moisture. The bedding store and monk store should be relocated to the new sala entrance attic.

## Retreat Centre

The retreat Centre will need containers as buffer space for the phase 7b transition

**Containers** needed:

1. Storage Container
2. Storage Container (?)

Might need a better estimate (?)

## Phase 7b

The Vihara will have to store some of the furniture in containers during the construction phase. Computer room, IT admin and media room can be relocated to the main office (freed from Site manager office). Sawing room can be relocated to Sala Monk Eating room.

**Containers** needed:

1. Storage Container
2. Storage Container
3. Storage Container (?)
4. Storage Container (?)

Might need a better estimate (?)

## Phase 7b+

Containers will be used for the transition of the next phase as well (demolition of old workshop and Karunasom), but the containers of the 7b transition will be free by then.

## Barn

Some discussion about the barn were made. Needs a purge and organisation.

Note: Heartwood house has been kept outside the discussion (could be used after the phase7b for storage as well?)

# Conclusion

Playing it safe, we conclude at the meeting that we should buy all the containers. Use 4 of them for the book storage, 2 of them for the retreat centre and 4 of them for the Vihara Transition (phase 7b).

An accurate estimate of the need of transition storage for the retreat centre and Vihara could be done to see if we could do with less containers, but it is hard to make precise projection.

The cost of sending back containers to the company is around 300GBP and thus make it more attractive to buy them as well. If we own them, we can modify them to fit our need.

# Action Points

- ☐ **Eleonora & Caroline:** Ask for a quote to but the container of each type (& provide comparison of the price with the renting price)
- ☐ **Eleonora:** Investigate how easy would it be to sell the containers in 10 years time ?
- ☐ **Eleonora:** Rename the containers with number and label them.
- ☐ **Who:** Liaise with ADL about the decision
- ☐ **Eleonora:** Refurbish the two larder containers.
- ☐ **Work Monk:** Remove Joshua awnings
- ☐ **Eleonora:** Move the two larder containers next to Joshua containers
- ☐ **Work Monk:** Empty Joshua Containers
- ☐ **Eleonora:** Emptying the other containers (sell or dispose of items)
- ☐ **Work Monk:** Move books and book store into new containers
- ☐ **Work Monk:** Move bed store and monk store to Sala Entrance Attic

# References

<https://www.portablespace.co.uk/product/20ft-x-8ft-one-trip-shipping-container-blue-ral-5013>



## 20FT SHIPPING CONTAINER (ONE TRIP) BLUE (RAL 5013)

Quickfind Code: 620

Part Number: SALE 20FT STD ONE TRIP 5013

**£2,275.00** (exc. VAT)

**£2,730.00** (inc. VAT)

 **Asset finance available.** Find out more

 **Available to purchase now**



**QUANTITY:**



Add to Basket



## 20FT X 8FT STEEL ANTI-VANDAL OFFICE

Quickfind Code: 655

Part Number: SALE 20X8 OFFICE

**£8,909.00** (exc. VAT)

**£10,690.80** (inc. VAT)

 **Asset finance available.** Find out more

 **Available to purchase now**



**QUANTITY:**



Add to Basket

Revision #6

Created 6 April 2025 07:58:47 by Cittadhammo Bhikkhu

Updated 14 April 2025 08:03:41 by Site Manager (Eleonora)