

Storage

Storage is a general term that cover moving out of the storage from the RC and the containers. Some will go to the multipurpose room, some will go in the attic, some will go in other cupboard I imagine.

Person in Charge

Samahito Bhikkhu and Ajahn Jivako

Responsibilities

1) Inventory

- **What do we have**
 - Books (RC + Container)
 - Furnitures (RC + Container)
 - Entrance RC
 - Blue containers
 - General store (boiler room)
 - Sala container
 - RC (Maria)
 - Book
- **Where does it go (3 attics) See photos and video here**
 - Multipurpose room
 - Sluices
 - Kitchen

2) Making sure we have what we need for transferring

- Enough shelves (buying)
 - with padding on the feet
- Box
- temporary box (cardboard)
- Lifter for the attic?: (price is around 200£) video

3) Action plan for transitioning

- work monk process what to do, etc.

Strategy

Having a clear idea of:

- **Space** (what are the storage locations)
 - Have a list inventory of all location: RC rooms, RC Kitchen, RC container, ...
- **Time** (what needs to go where when)
 - Purge Pile and Moving Pile when destocking
- **People** (who is involved)
 - People un charge of the different spaces
- **Communication** (how to communicate)
 - Have a meeting with the parties involved and keep track of the main plan.

Space Inventory

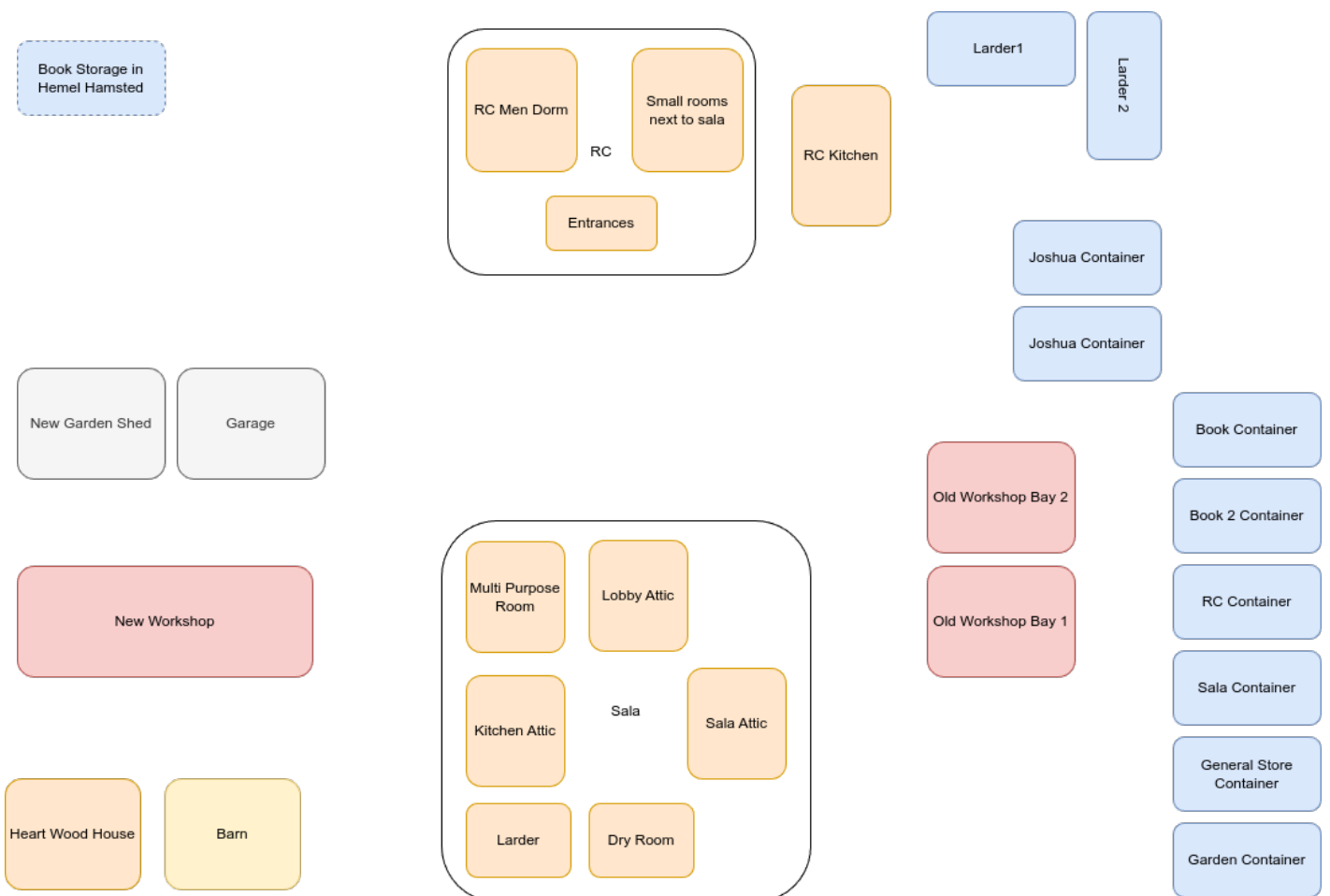

Note:

- Need more detailed inventory of rooms in RC, RC Kitchen, Sala.
- Could consider Heartwood House.
- New Workshop only available in late December

Room inventory

Room	What is used for (kind of storage)	Commentary
<u>Attic 1</u>	Frames, pictures, Buddha rupas and Kathina / Festival items	
<u>Attic 2</u>	Shelves + furniture from the RC storage	
<u>Attic 3</u>	Shelves + furniture from the RC storage	
Workshop Attic	Books? Other big furnitures?	
Multipurpose Room	General supplies: Everything from the General supplies container.	

Items Inventory

[See photos](#)

Storage Transition ABM

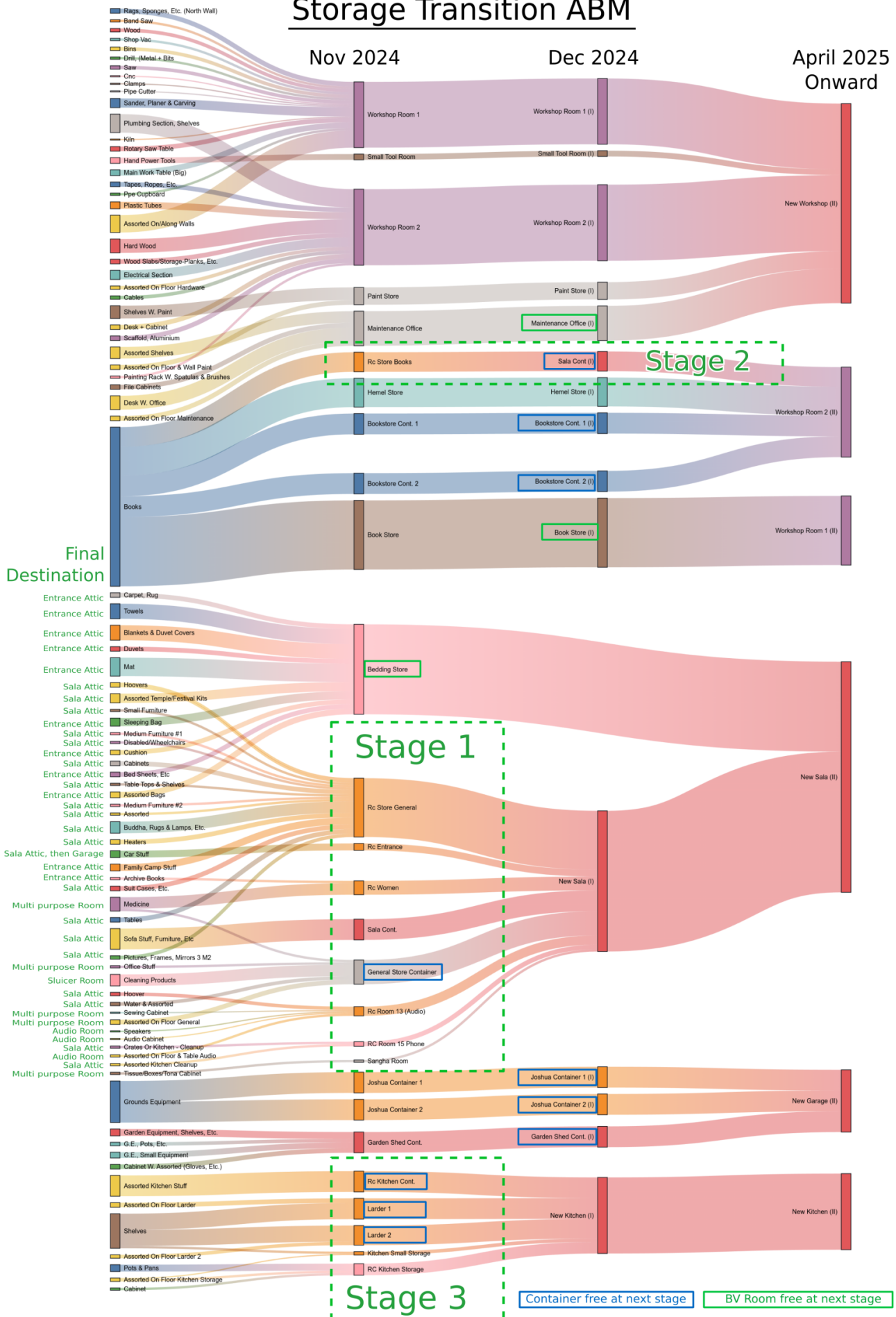

Shelves inventory (see photos)

Type	What is used for	Where	Height (cm)	Width (cm)	Depth (cm)
<u>Wooden furniture</u>	Art ressources	RC Storage	68	203	
<u>Wooden shelf</u>	Family camp items	RC Storage	60	180	
<u>Mounted metal shelf 1</u>	Buddha rupas, micro-waves, lamps, heater, indoor items	RC Storage	378 (2*187)	200	60
<u>Mounted metal shelf 2</u>	Hoovers, wheelchairs, chairs, little tables	RC Storage	198	200	90
<u>Mounted metal shelf 3</u>	Large chairs, small tables, small furnitures, other small indoor items	RC Storage	286	200	90
<u>Mounted metal shelf</u>	Festival and Kathina items	Sala container	153	200	62
<u>Plastic shelf 1</u>	Festival and Kathina items	Sala container	183	89	39
<u>Plastic shelf 2</u>	Festival and Kathina items	Sala container	183	89	39
<u>Plastic shelf 3</u>	Festival and Kathina items	Sala container	183	89	39
<u>Metal Shelf</u>	Festival and Kathina items	Sala container	198	100	45
<u>Metal Shelf</u>	Medicine + Supplements	General supplies container	192	91	47
<u>Wooden Shelf</u>	Office items, torches, batteries	General supplies container	194	82	32
<u>Mounted metal shelf 1</u>	Bathroom and kitchen cleaning items, paper towels, bin bags	General supplies container	378 (2*187)	200	60

Type	What is usedfor	Where	Height (cm)	Width (cm)	Depth (cm)
<u>Mounted metal shelf 2</u>	Cleaning items, hygienic items	General supplies container	378 (2*187)	200	60
<u>Mounted metal shelf 3</u>	Water and other cleaning items	General supplies container	215 (2*105)	200	

Sketches and advices

the shelf storage in the attic - including the workshop - needs a rubber support to spread the load on the floor.

Rubber support foot

Non-slip rubber self adhesive - For our use, I think it is a good option.

The structural engineer estimated the attic allowable loading as a guideline in their drawing.

The central zone (1) can store six bags of 25kg rice stacked vertically on top of each other
OR
The central zone (1) can store 4 crates 585mmL x 385mmW x 240mmH stacked vertically on top of each other, each carrying up to 30 litre liquids - apple juice, milk etc..
(if lighter products are stored, like dried pasta, the number of crates stored could be increased)

CORBETT & TASKER
structural engineering
Job: Amaravati Sala
Nr: 21520 Drn: MGB Check: PJC
Date: 09/06/2021 Scale: 1:50 @ A4 UNO
SK09 - Attic Allowable loading Sketch

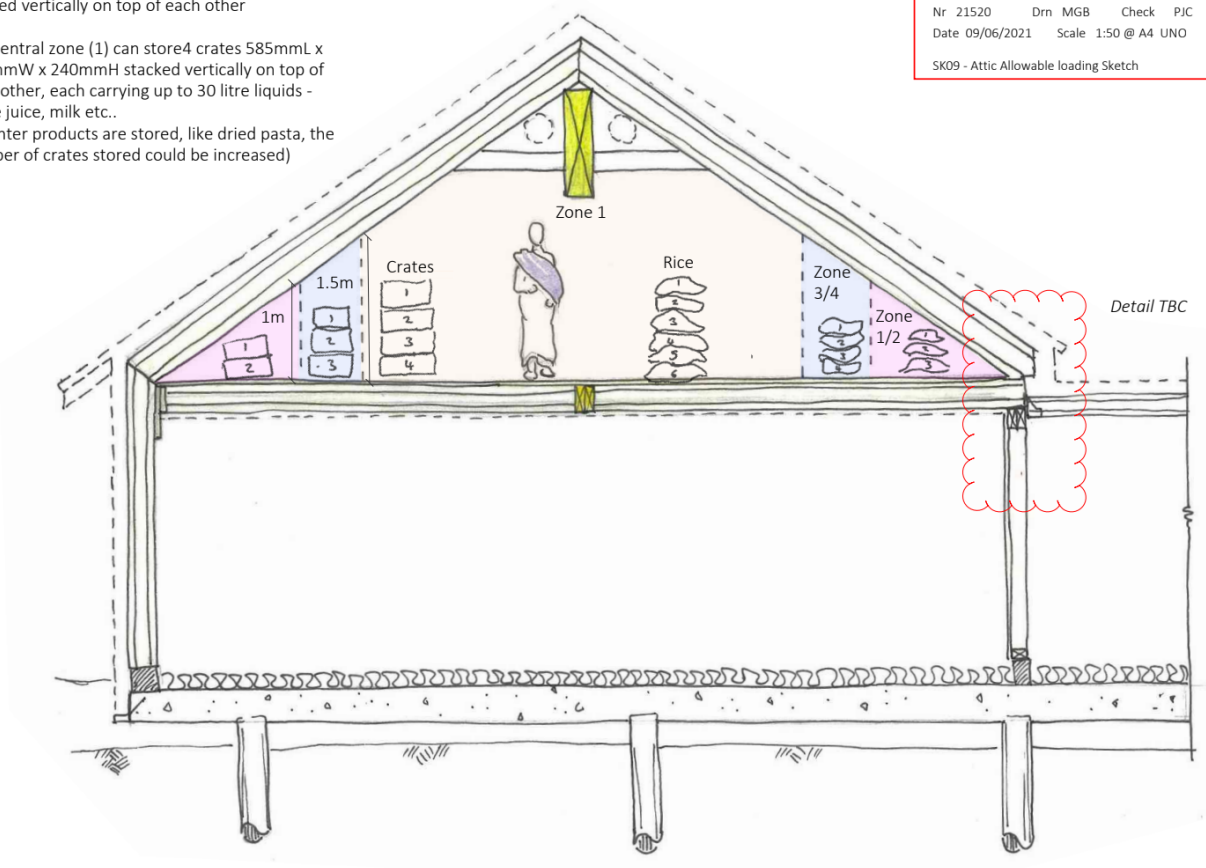

Blue Containers

- What to do with the Blue containers?
- Renting containers for 2-3 years is equivalent to buying them
- Will they be used for 7b? [Q]. To be decided, input from ABC required.

Kitchen

Hand Measurement of the Larder Room

Ceiling Height : 2598mm

Ceiling Height under Pipe: 2219mm

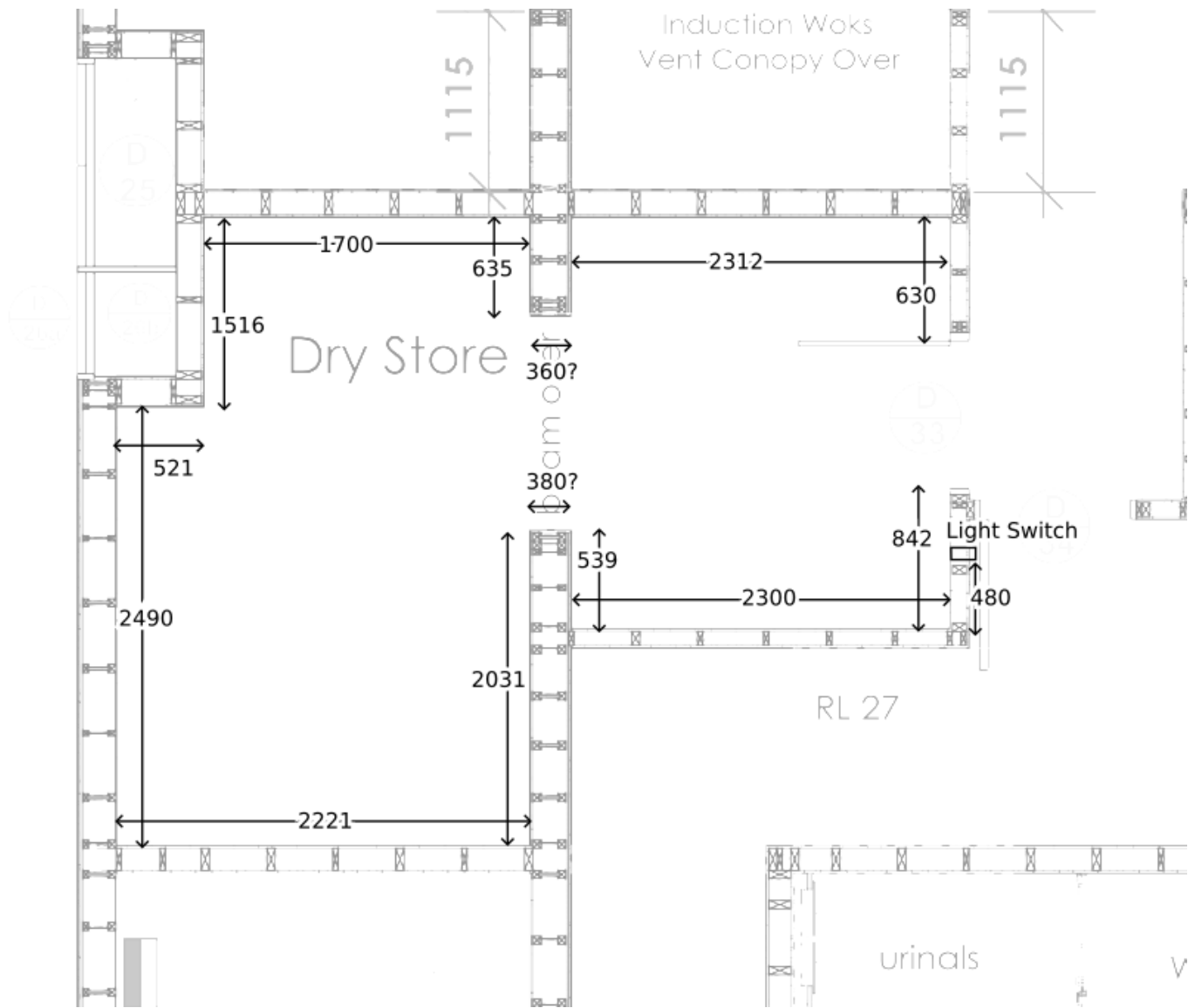

Cleaners Sluice & Store

It was intended to store cleaning materials, mops, buckets, vacuum machines.

see [Living Spaces](#)

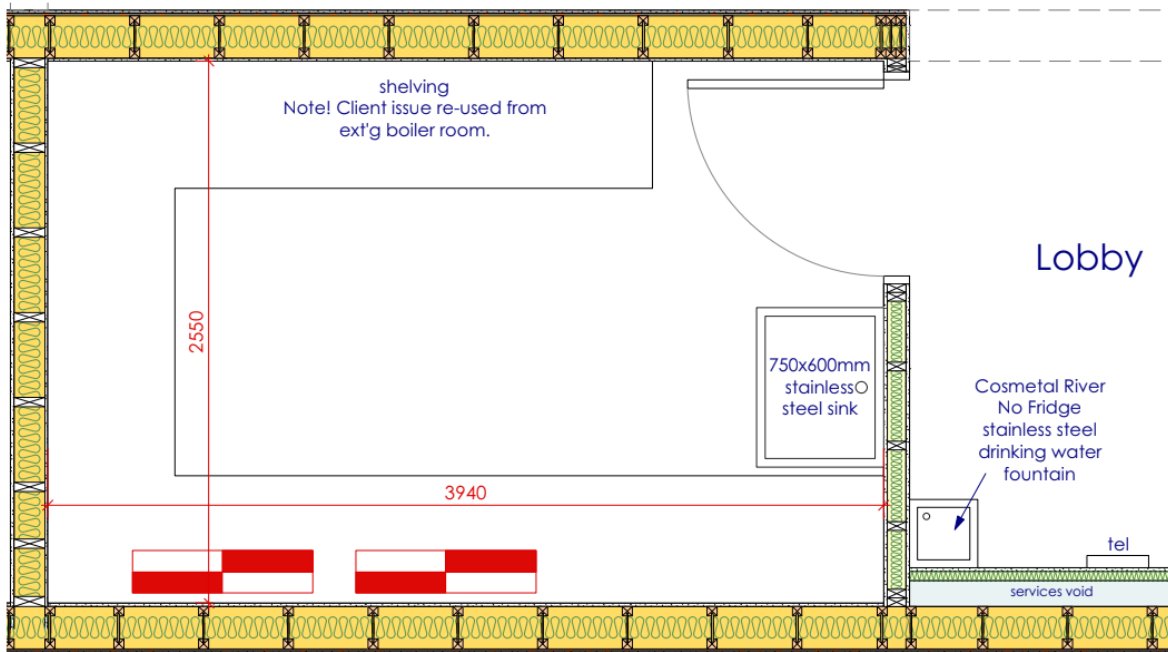

Revision #50

Created 1 August 2024 10:02:40 by Cittadhammo Bhikkhu

Updated 3 December 2024 09:48:28 by Cittadhammo Bhikkhu