

Storage Workshop Transition



Responsibilities

Ajahn Jivako + Tan Samahito

Shelvings and bins: Tan Balado

Inventory: Tan Karunno

Purge: Tan Issaro

Steps

1. Inventory of what we have (shelves and items) (April to July)
2. Get what we need (shelves and boxes)
3. Make a plan of where things go (futur)
4. Move all the stuff when it is ready (futur)

Plan of the workshop

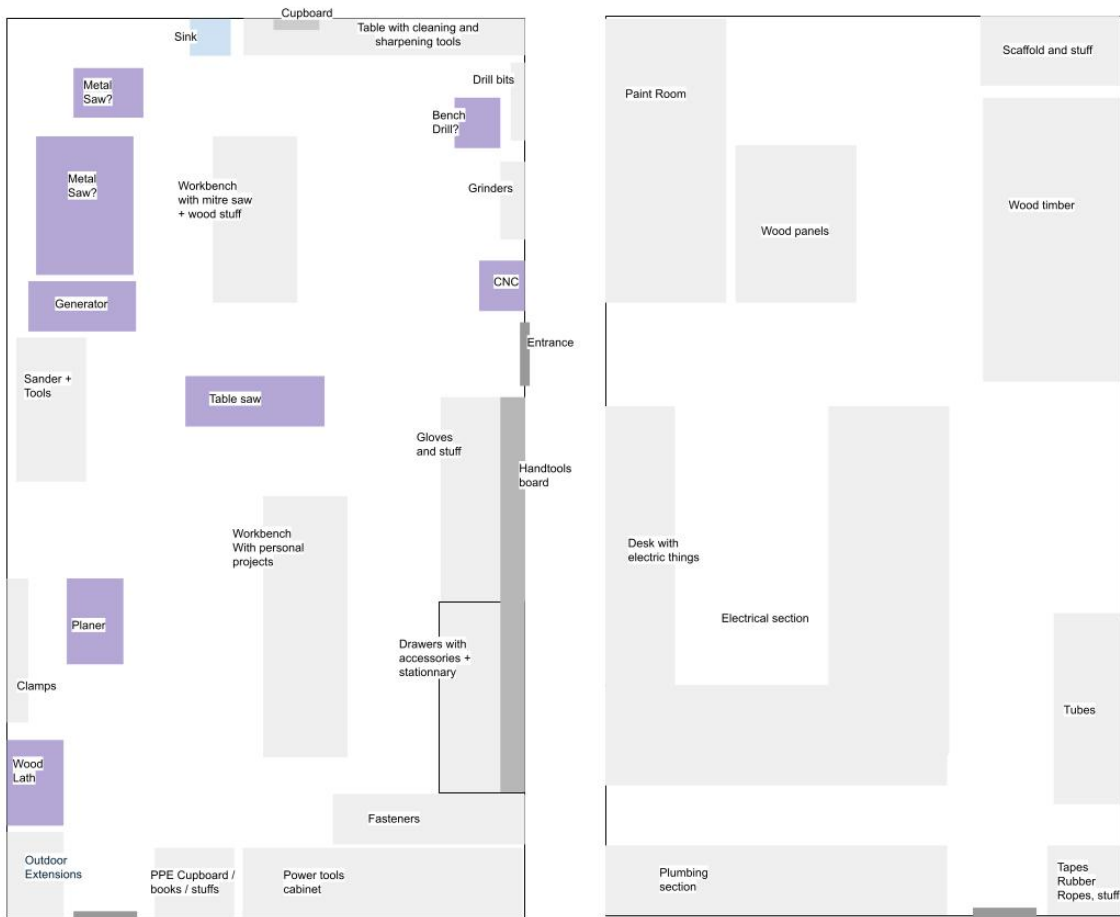

Sections

- Electric section
- Plumbing Section
- Paint store
- Hard wood store
- Power tools store
- Hand tools store
- Personal project store
- Soft Wood stores
- Panels Stores
- Pallet Stores
- Plank Stores
- Metal Stores
- Sign Stores
- Scaffolding planks stores

Shelves Inventory

In charge: ???

Location	Quantity	Width (m)	Height (m)	Depth (m)	Layers
Bookstore	5	1.54	2.44	0.62	To check
Bookstore	1	2.40	2.50	0.90	To check

Items Inventory

In charge: ??? (Sister Nyanasiri for the painting?)

- Going through each section of the old workshop, make a list of what we have.
- Start with Hardware section
- For each section, check if we need boxes
- Put aside things we don't need.

Store	Item	Quantity	??	??	??
Hardware section					

What go where? (next step)

Revision #9
Created 18 April 2025 09:29:57 by Samahito
Updated 22 April 2025 14:17:21 by Samahito