



# Audio & Video proposal - 6s

T. Narindo and T. Jalito

Working document - current version 25 November 2021



Audio & Projector - T. Narindo

Both eating areas will have their 'mini' setup of mixer/amplifier and hearing loop. This make it simple to turn on the system whenever needed. Also the sound from the sala will be audible if required, however if a microphone is used inside the eating areas, it will not be possible to be heard in the other areas.

The idea is to divide the audio and video equipment over 4 areas. This seems to be 'better' than have this all in the AV room. It keeps the setup 'simple', which makes it easier for people to turn on the audio/video rather than to have it all connected up in one space with multiple zones/microphones options. Also, this allows us to keep the system similar to places like temple and the RC. We will continue to use analogue rather than moving to the more complicated digital systems.

Similar to the temple, we hope to have a audio in-wall cabinet. This makes it easier to control the volume (while being in the same room) and avoids those who operate it getting confused (read: messing up) the AV audio system). This system has worked well so far in the temple. This area will also be used by the video and projector.

**Note:** the division is that here we will place the microphone mixers, wireless mic receivers, card recorder. All of which can be operated by the audio monk. The av room will contain all the speaker cabling, amplifiers, line distributions and hearing loop systems.

Audio areas in the sala

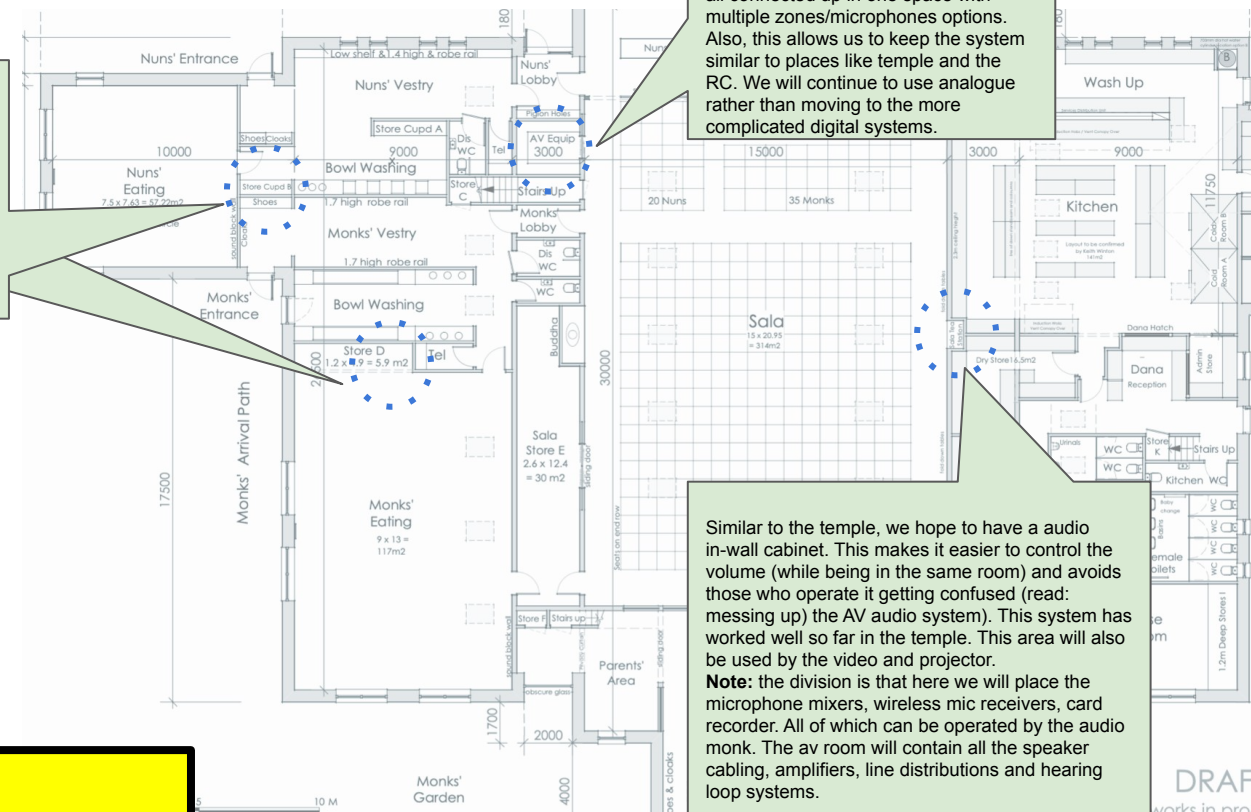

DRAFT  
works in prog



These are 100v speaker cable lines to receive sound from the **AV room** to the **temple audio room** and vice versa (2 separate cables). No termination plate. Just ending with two wire speaker. This will be converted using [this](#).

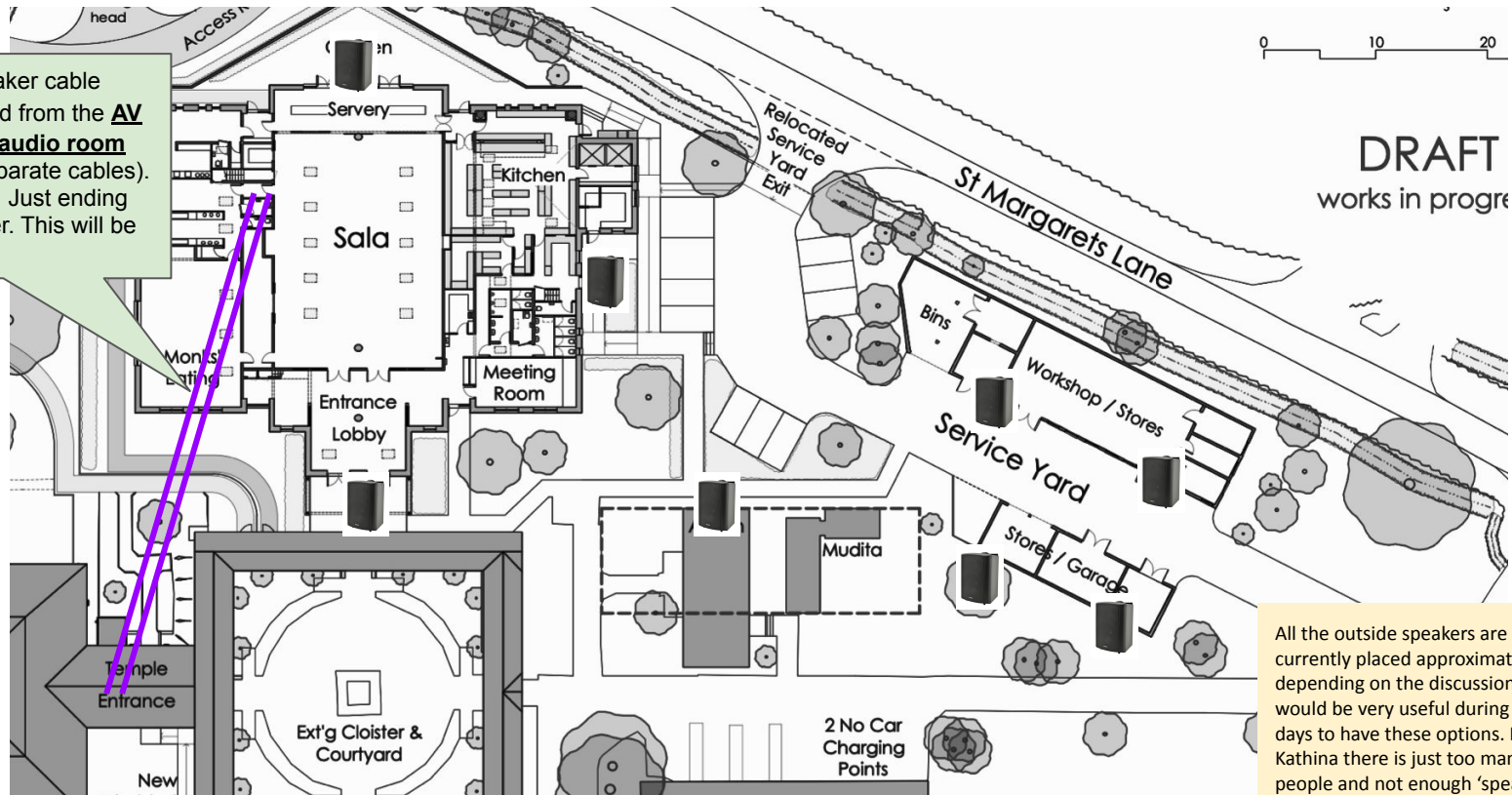

DRAFT  
works in progress

All the outside speakers are currently placed approximately, depending on the discussions. It would be very useful during festival days to have these options. During Kathina there is just too many people and not enough 'speakers' to keep everyone informed. Note: ideally in detail I would like to suggest some junction boxes so we can 'add' more later if needed.

Speaker system/line for outside the temple: due to the long cable runs, we use constant-voltage system 100v.



FP: Female  
XLR plate



MP: Male  
XLR plate



At the audio cabinet and  
AV room we can use a  
more complex wall plate  
due to the multitude of  
connections.

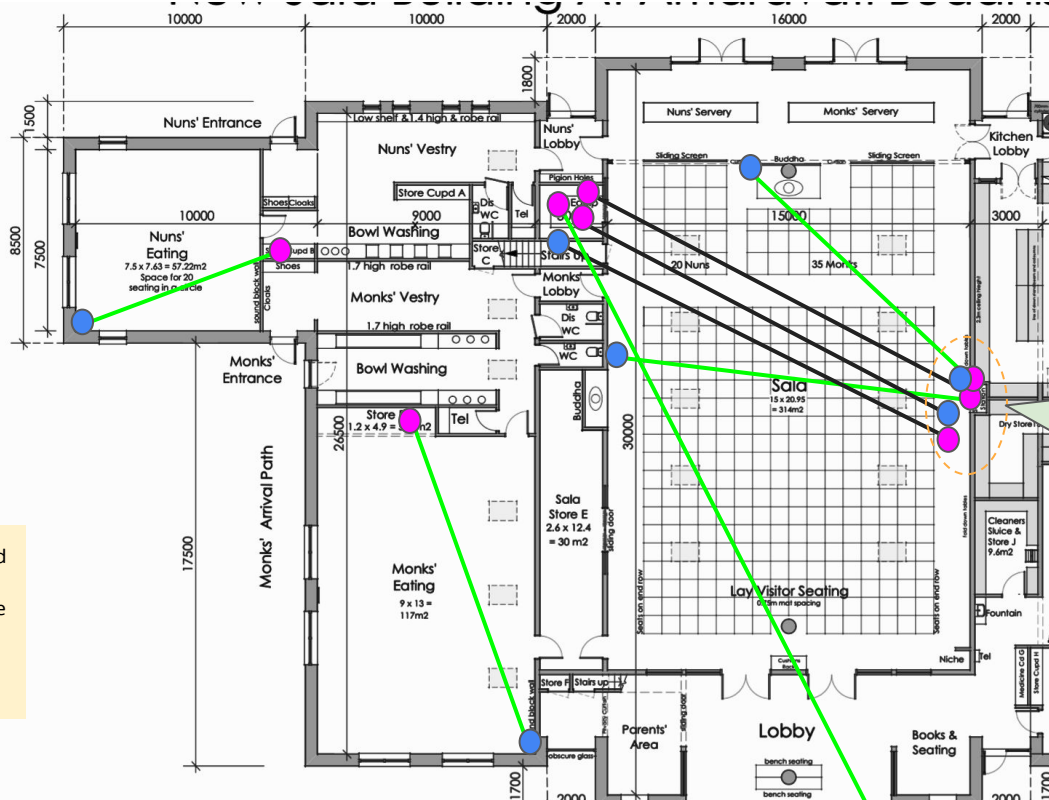

**Audio in wall cabinet:** This can be below or next to the video cabinet suggested later. Ideally on this spot. The orange circle indicates that all these connections should stay together.

**Request not on drawing:** in the audio cabinet we wish to have an on/off switch that turn on a double electrical socket in this cabinet + 4 electrical sockets in the AV room. With this switch we can turn on the sala audio system without needing to access the AV room.

**Outside:** here we would like to have an XLR connection + **Electricity socket (request not on drawing)**. We sometimes at festival need to have a wireless microphone, which can then be connected there. **Note:** the video slide will also make use of this area.

Microphone cables and the male/female XLR wall plates





Would be good during install to properly mark the cabling for the loop system. Otherwise it is 'just' a cable under the carpet/ground. Picture taken from [contacta](#).



**Hearing Loop**  
Switch hearing aid to T-coil

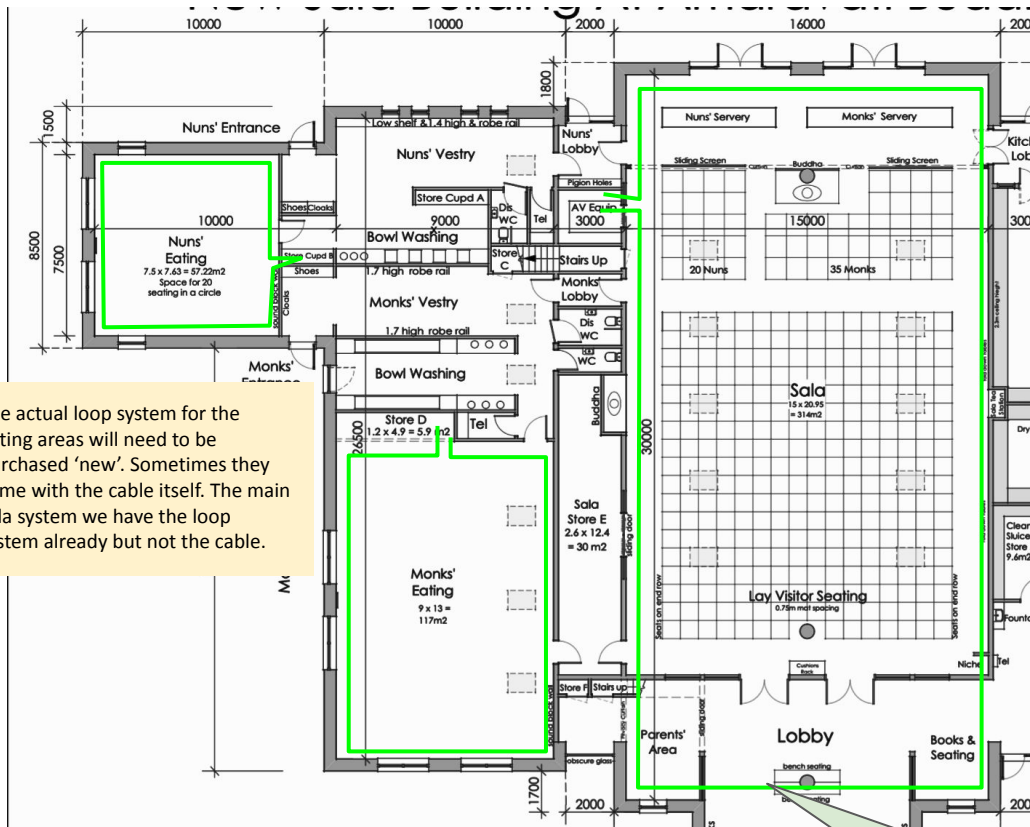

The actual loop system for the eating areas will need to be purchased 'new'. Sometimes they come with the cable itself. The main sala system we have the loop system already but not the cable.

If possible, include the lobby area, if not the loop can stay within the main sala area.

Loop system cables: tri-rated cables. Thickness depends on final cable length

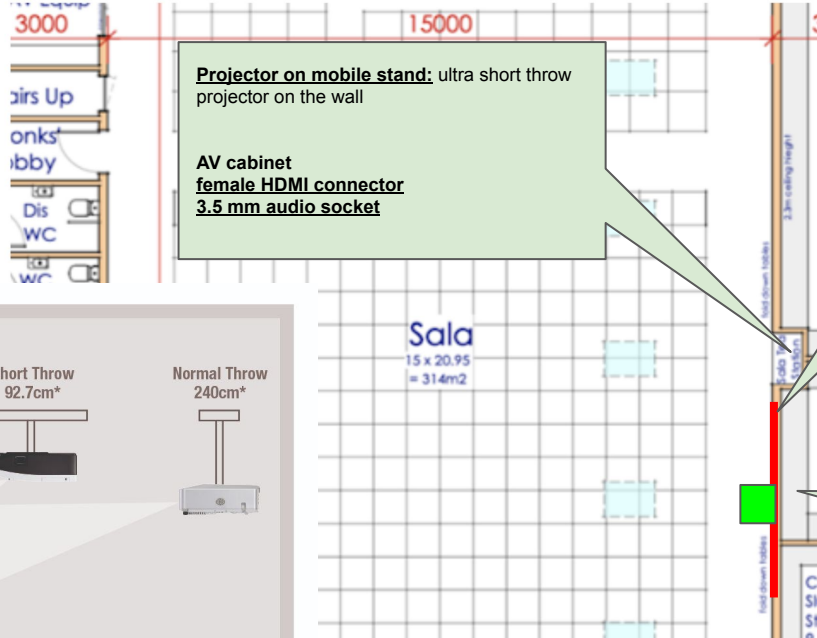

**Projector on mobile stand:** ultra short throw projector on the wall

**AV cabinet**  
**female HDMI connector**  
**3.5 mm audio socket**

**Projector from the ceiling:** we would like to reuse our current projector 100 inch screen that can retract by remote control. The size of the retracted projector screen is 335cm long x 14cm x 10cm), screen can drop 200-220cm.. This screen requires **electrical socket**. On the left you can see that we have a 2 way control, if possible we can expose the wired panel, if not, we can only use the remote control.

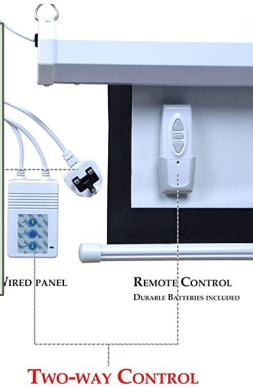

**Projector cabling:** The connections to projector from AV cabinet tea station  
 Female HDMI connector  
 3.5 mm audio socket  
**Ethernet / network socket (via T Nipako)\***  
**Power socket**

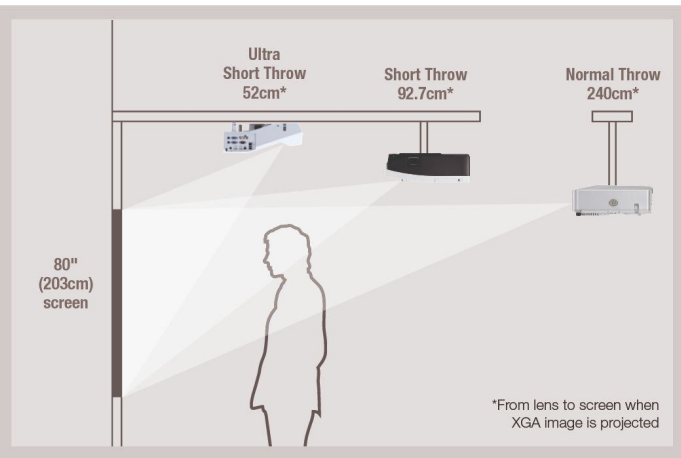

Projector and projector screen



## 6S - VIDEO & LIGHTING

1. SUGGESTED VIDEO CAMERA SYSTEM
2. CAMERA FORM FACTOR
3. SUGGESTED VIDEO LIGHTING
4. LIGHT FIXTURE FORM FACTOR
5. TEMPLE AND CLOISTER

EXAMPLE VIDEO CONNECTION - SDI connection (4K capable)



EXAMPLE NETWORK SOCKETS (RJ45)



# SUGGESTED VIDEO CAMERA SYSTEM

## LOCATIONS , CABLING AND FORM FACTORS

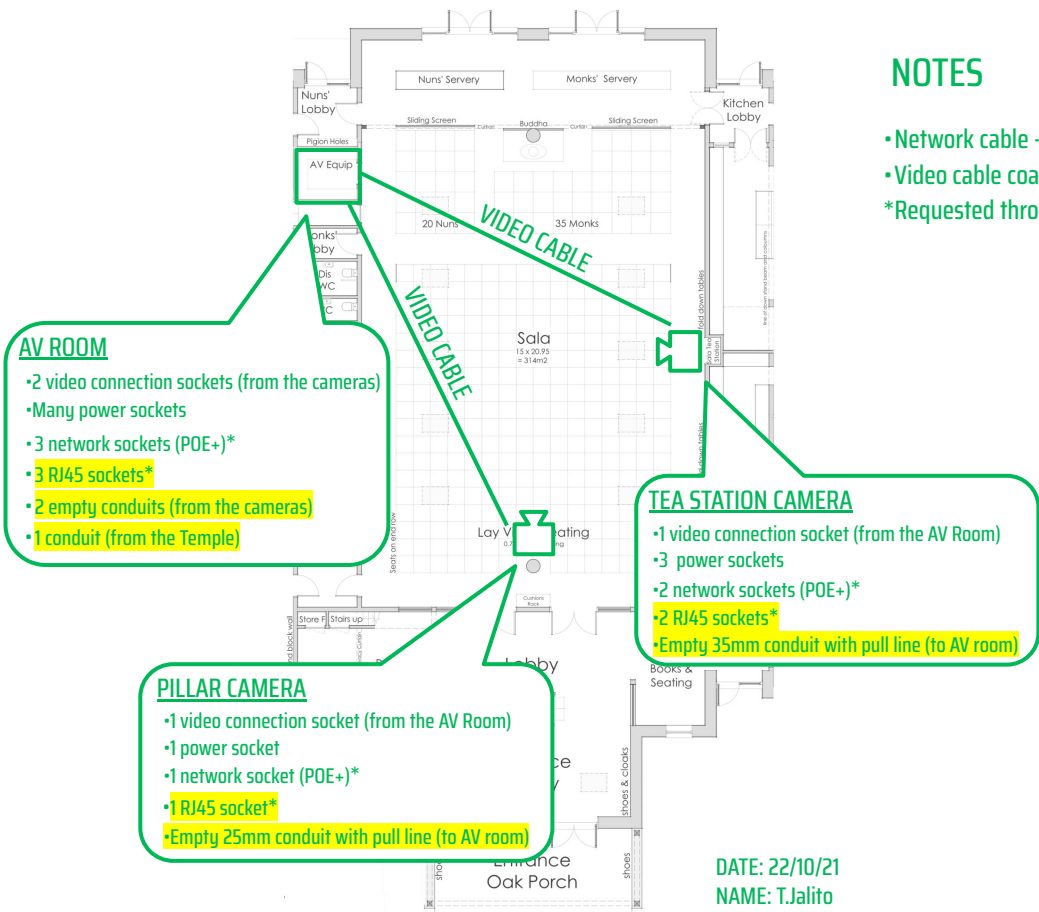

### NOTES

- Network cable - CAT6A (solid core copper)
- Video cable coaxial 4G capable
- \*Requested through Ven.Nipako

DATE: 22/10/21  
NAME: T.Jalito

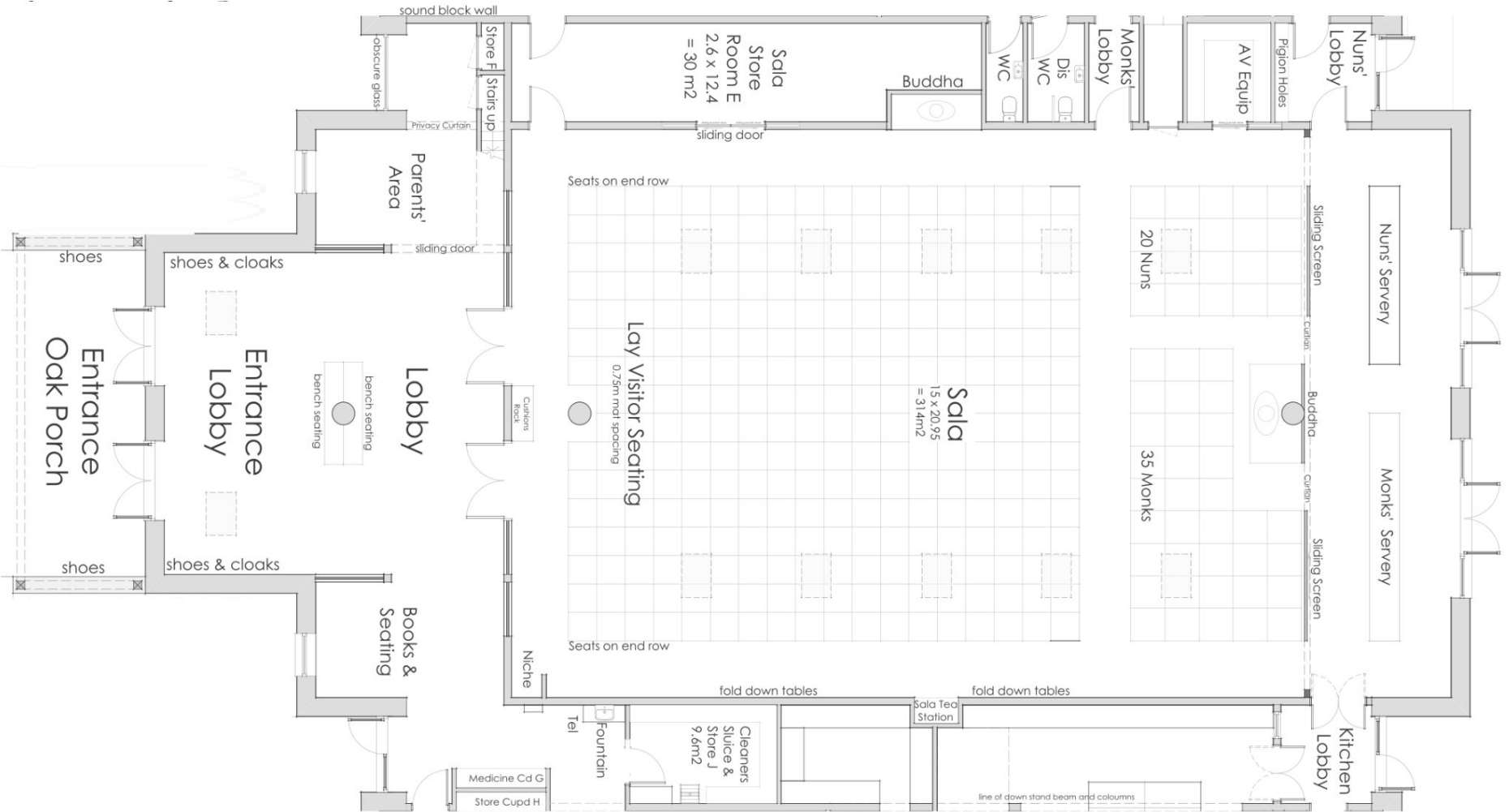

EXAMPLE LIGHTS ON/OFF SWITCH



EXAMPLE LIGHT POWER SOCKETS



EXAMPLE LIGHT CONTROL SOCKETS



EXAMPLE LIGHTS CONTROL DIAL



EXAMPLE LIGHT FIXTURE MOUNTING POINT



SUGGESTED VIDEO LIGHTING  
LOCATIONS , CABLING AND FORM FACTORS

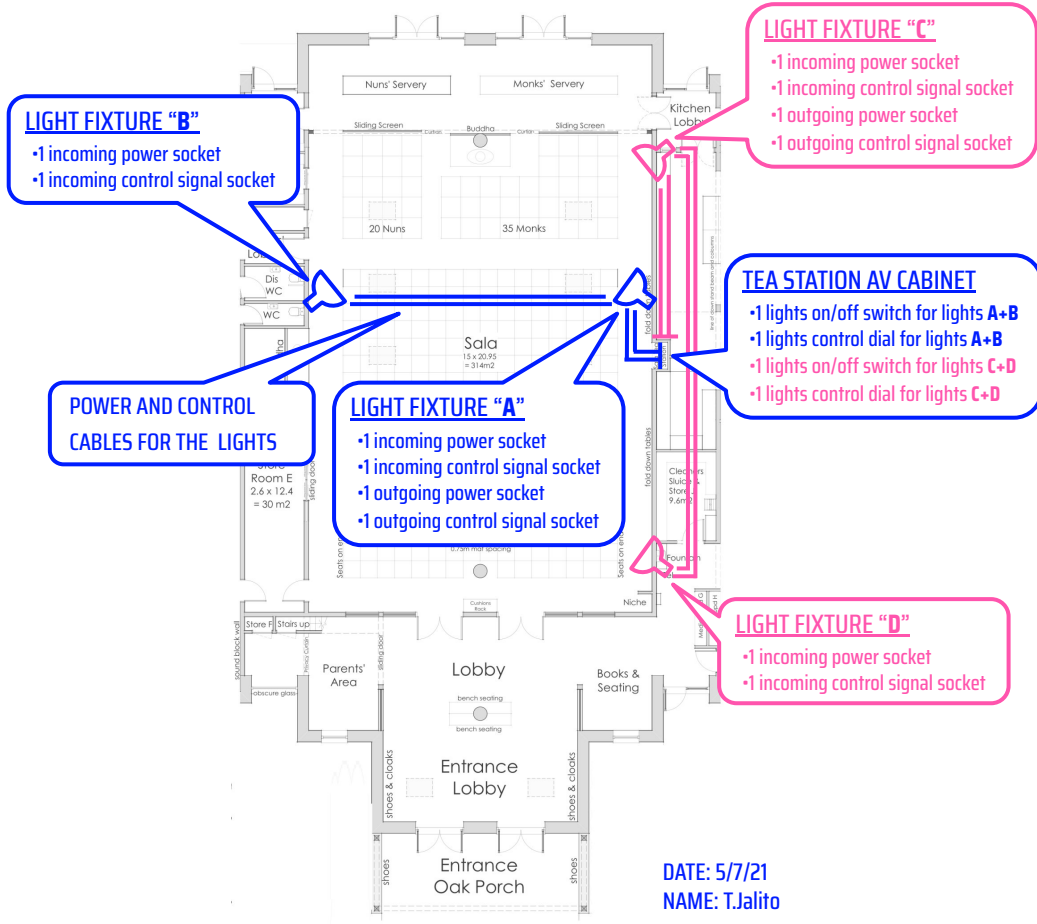

NOTES

- Light fixtures connected in a chain
- 2 light chains - 2 fixtures per chain
- 4 light fixtures altogether
- Each light fixture requires a mounting point
- Each light fixture requires multiple power sockets (2 to 4) nearby
- Lights on/off switches and control dials located in the Tea Station AV Cabinet
- Each light chain requires its own on/off switch and it's own control dial
- Lighting control cable - 3 core DMX
- Lights control dials require power to operate ([manufacturer's information](#))

DATE: 5/7/21  
NAME: T.Jalito

# TEMPLE AND CLOISTER VIDEO EQUIPMENT CONNECTIONS

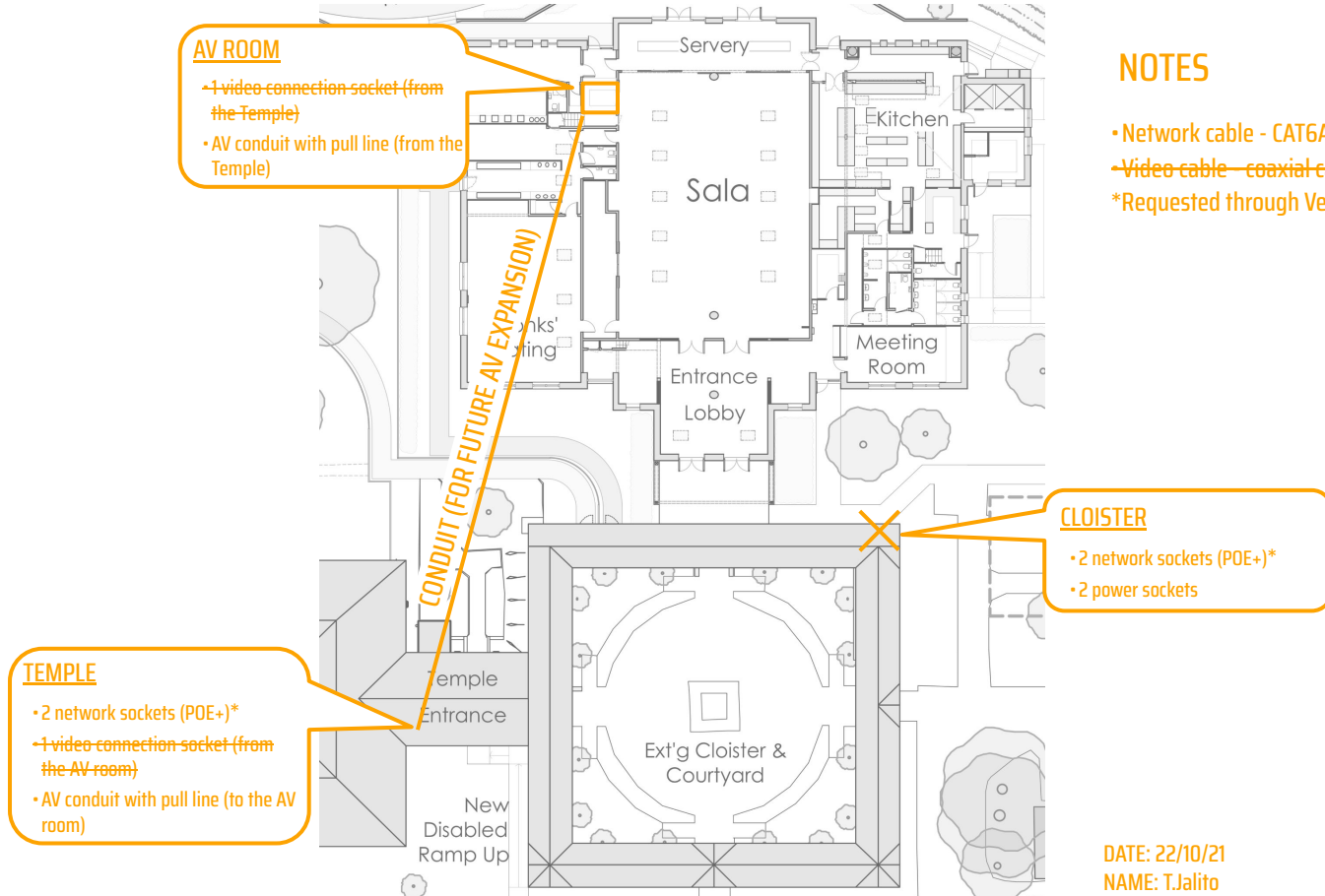

## NOTES

- Network cable - CAT6A (solid core copper)
- ~~Video cable - coaxial cable (36 SBI rated)~~
- \*Requested through Ven.Nipako

Tea station / *AV* room design



# TEA STATION CAMERA SPACE

## LOCATION & DIMENSIONS

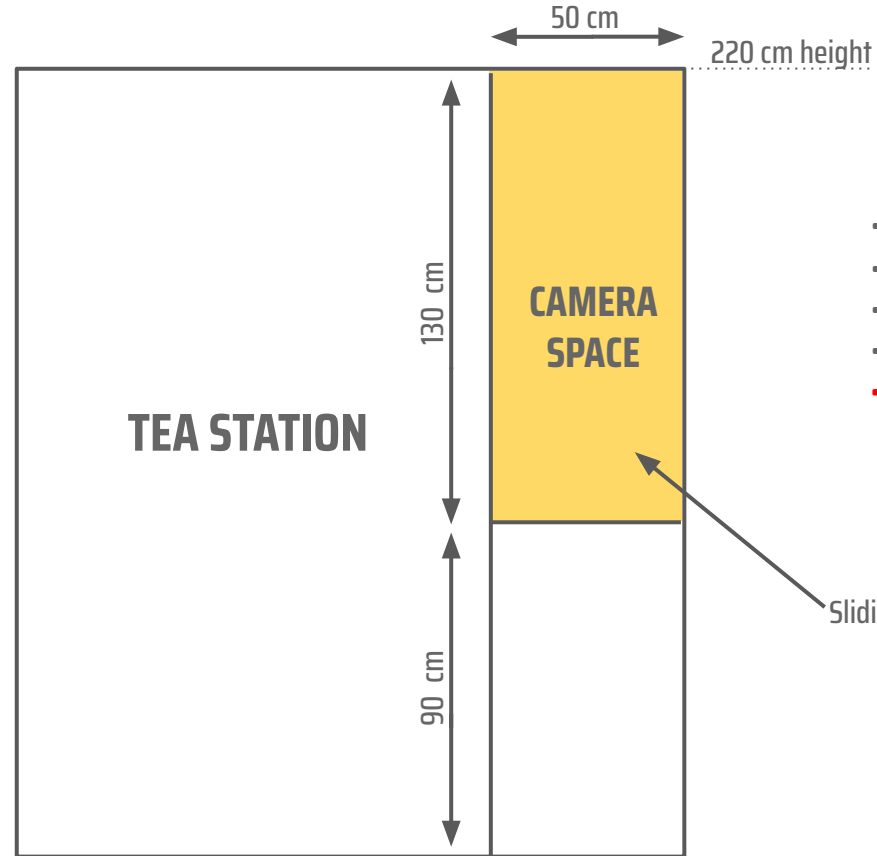

## DESCRIPTION

- Height: 90cm to 220cm
- Width: 50cm
- Depth: 45cm
- Sliding lockable door
- **The camera must be directly across (facing) the shrine**

DATE: 22/10/21  
NAME: T.Jalito

## AV room shelving

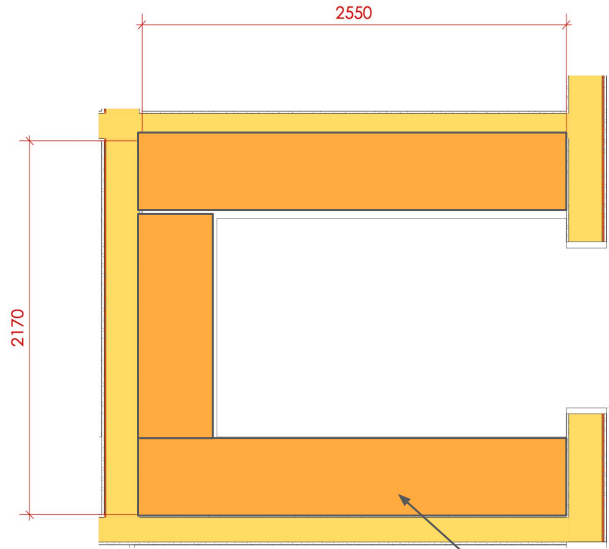

Slide door, no swing door. Slides from north to south

Top shelf starting at 200cm. 45 cm deep. Going around in U shape. Assuming the ceiling is no less than 250cm.

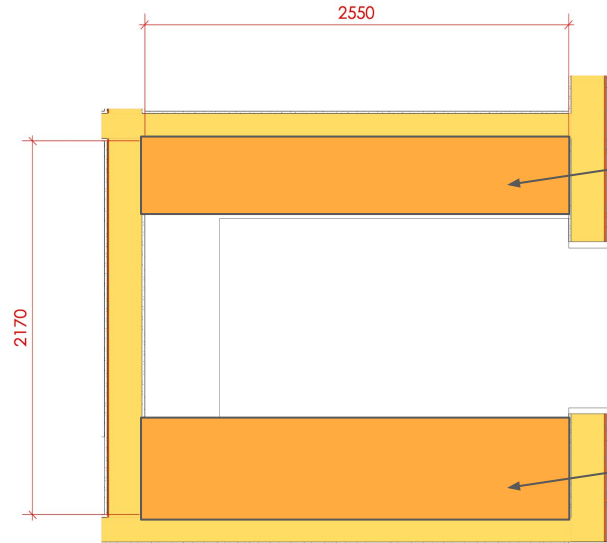

Bottom shelf starting at 80cm. 45 cm deep.

Bottom shelf starting at 80cm. 60 cm deep. Need carry / hold 100kg minimum

## AV room general electrical sockets

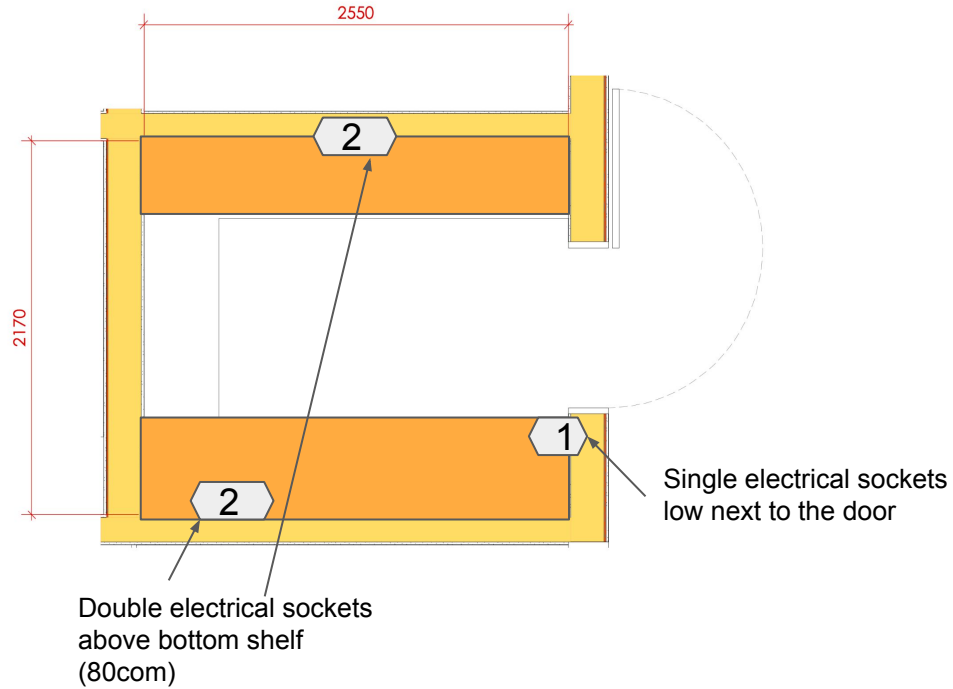

## AV room audio / video sockets

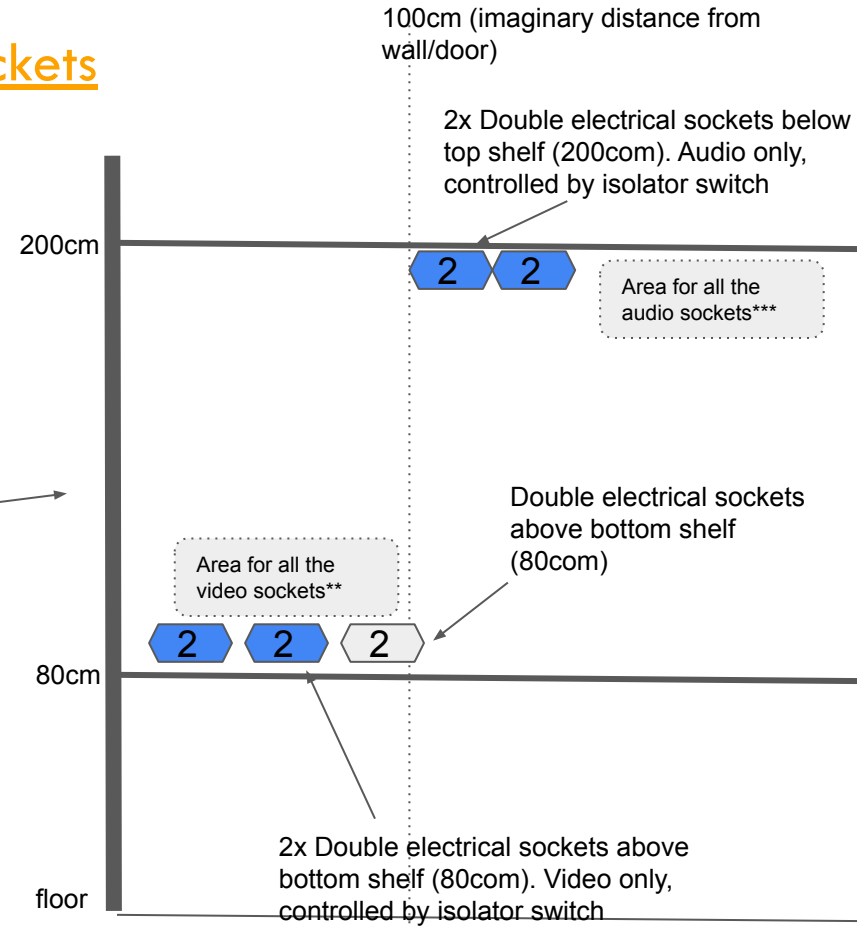
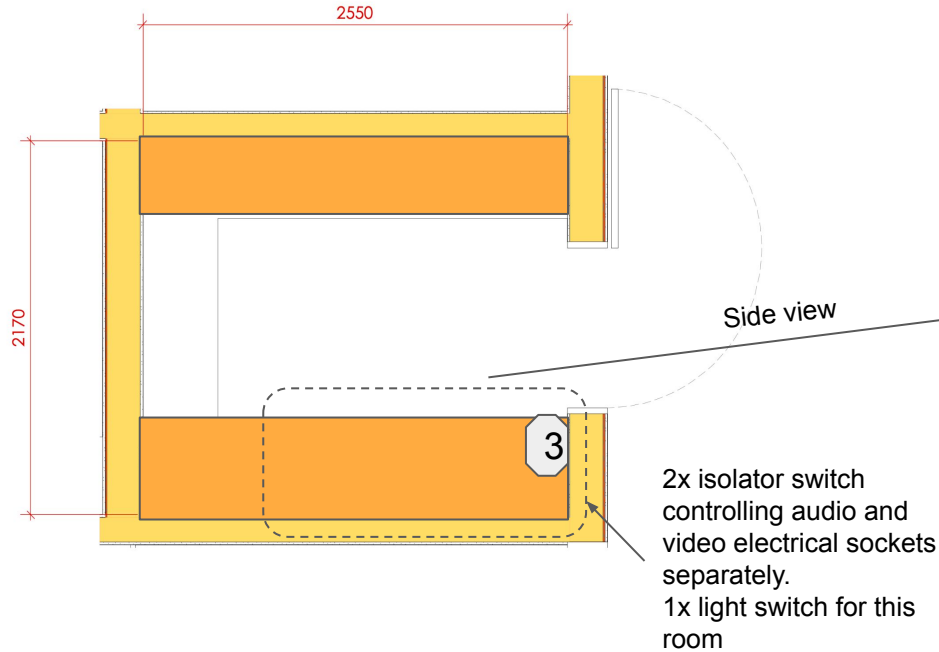

\*\* video sockets see slide 13

\*\*\* audio sockets see slide 5,6,8,9

# APPENDIX

(details on items)

# A proposal for audio and video fixtures and cabling - 6s

This proposal is drafted by Tan Narindo and Tan Jalito after we have met with a small group from Amaravati suggested by the 6s Team. The biggest question mark will be the eventual use case of the space, some of it will remain in the realm of speculation. We tried to cover the obvious requirements and suggested/included some possible future use cases of the space.

In the design of the system we tried to standardise the system with our current way of working, this avoids our community to learn two types of audio/video systems and maintain it. Also simplicity has been chosen above more capable/flexible equipment, but often more complex and difficult to operate.

We have also proposed some 'alternative' equipment, so hopefully a most proper one could be chosen so it can blend 'better' with(in) the new buildings.





**The ceiling speakers at the lobby area, hallway and MultiPurpose meeting room:**

CMX20T. We have 8 of those that can be re-used from the current sala. They used to be in the temple.



Wall with bracket  
(black) for  
monks/nuns eating  
area

**Speakers (nuns/monks eating area, kitchen, outdoor):** Outdoor weather proof speaker (black or white): Cost around £50. These are quite universal in use.

Speaker Type suggested on previous slides



**The 4 sala main area speakers**

JBL Speakers (same as temple), wall mounted. They are specifically for area with high reverb/echo. They work really well in the temple. To keep this 'simple' we hope to re-use the same setup. So it is easier for use to maintain similar systems than 'new' ones. Optionally they could be coloured/painted

## LIGHT FIXTURE FORM FACTOR



APPROX. DIMENSIONS:

HEIGHT: 25cm

WIDTH: 20cm

DEPTH: 25cm

## ALTERNATIVE FORM FACTORS



## COMMON INSTALLATION METHODS



DATE: 5/6/21  
NAME: T.Jalito

## CAMERA FORM FACTOR



APPROX. DIMENSIONS:

HEIGHT: 20cm

WIDTH: 20cm

DEPTH: 25cm

## ALTERNATIVE FORM FACTORS



## COMMON INSTALLATION METHODS



DATE: 5/6/21  
NAME: T.Jalito